

1. Names and Parts

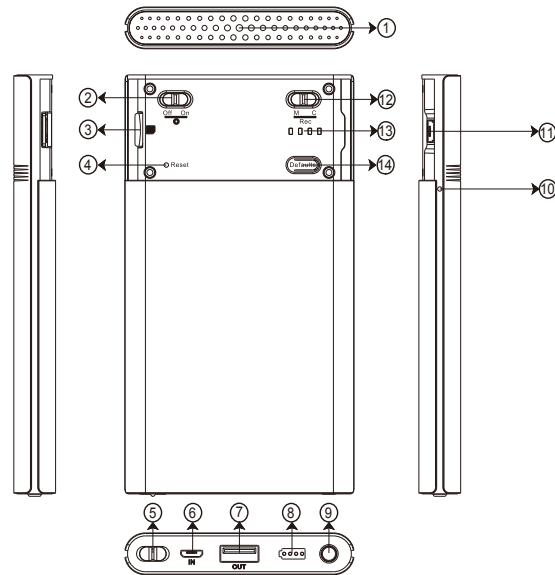

- | | |
|---------------------|--|
| 1. Lens | 9. Battery Bar Button |
| 2. WiFi Switch | 10. Microphone |
| 3. Memory Card Slot | 11. USB Port
(Retrieve Video Files) |
| 4. Reset Key | 12. Continuous Recording/
Motion Detection Switch |
| 5. Power Switch | 13. Status Indicators |
| 6. Charge Port | 14. Default Button |
| 7. DC 5V Out | |
| 8. Battery Bar | |

*No microphones are available for USA market.

1

2. Package Content

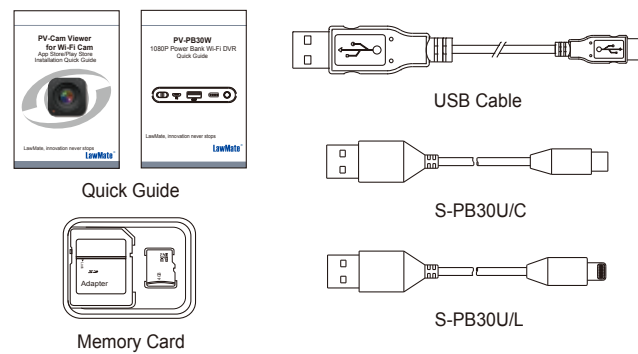

3. Open the cover



Dig in the side of the DVR and take the cover in red arrow direction. The cover will then be opened.

2

4. Recording Operation

It is highly recommended to format memory card first before using it for the first time.

- 3.1. Power on: Switch ⑤ to the right to turn on the device.
- 3.2. Recording: 7 seconds after the device is powered on, it starts to record automatically.
- 3.3. Wi-Fi: Switch ② to ON to turn on Wi-Fi function and switch to OFF to turn off Wi-Fi. Follow the instructions in PV Cam Viewer Quick Guide. The orange LED will be solid on when connected to Wi-Fi.
- 3.4. Power off: Switch ⑤ to the left to stop the recording and turn off the DVR.
- 3.5. Restore default Wi-Fi password: long press ⑭ for 3 seconds.
- 3.6. Restore all default setting : press ⑭ for 10 seconds.
- 3.7. Change the recording mode: Switch ⑫ right to Continuous recording mode; switch ⑫ left to Motion Detection mode.

5. Status Indicators

- Solid blue LED ■ - power on
- Solid red LED ■ - recording on
- Blinking orange LED ■ - device searching for Wi-Fi connection
- Solid orange LED ■ - device connected to phone (P2P connected)

6. Format Memory Card

- 6.1 Press and hold ⑭, and turn on the device. Release when the red LED blinks.
- 6.2 After the format is done, the device will automatically turn off.
- 6.3 You can also connect the device to your smartphone and format via the app PV CAM VIEWER.

*This product is for Law Enforcement and Home Security Use Only!

3

7. Retrieve Video Files

There are two ways to read the retrieve video files.

- 6.1. Use memory card reader to retrieve video files.
- 6.2. With the device powered on and memory card inserted, plug the USB cable into ⑪, and plug the other end into the PC. The device will be recognized by PC as an external drive for user to retrieve the files.

8. Battery Bar Indicator

LED Indicators	Battery Capacity
Three blue LED shining	65~100%
Two blue LED shining	35~ 65%
One blue LED shining	5% ~ 35%
One Blinking blue LED	No power
Three flashing blue LED	Device charging

4

9. Specification

External Camera Module	
Built-in Image Sensor	1/2.8" Progressive CMOS Sensor
Sensor Resolution	2592 × 1944
Sensor Sensitivity	3.3 Lux @ F 2.0
Lens F/No.	F 2.4+~5%
Focal Length	3.7mm
Angle of View	70°
Video Spec.	
Algorithm	H.264, JPEG
File Format	MOV, JPG
Video Recording Mode	Auto / Manual / Motion Detection
Recording Capability	1080P / 720P / WVGA
Frame Rate	Up to 30 fps
Photo Capability	2592x1944
Wi-Fi Spec.	
Wi-Fi	Built-in Wi-Fi Module
Storage & I/O	
Memory Type	Micro SD Card (Support SDHC max. 64GB) Use Device Format
Data Interface	Mini USB 2.0
Battery Output	USB DC 5V Output 550mA
Misc.	
Disguised Mode	Stand-By, Power-Off
Date/Time Table	YYYY.MM.DD, HH,MM,SS
Snapshot	Snapshot image when preview
Power	
Power Input	DC5V
Power Consumption	300mA-360mA (Wi-Fi off Wi-Fi = 100mA)
Battery Input	DC 3.7V / 4500 mA Lithium battery
Battery Lifetime	Continuous recording 600min for Wi-Fi off
Recording Time	5h @ 1920 × 1080 resolution (32GB SD card)
Charge Time	150min-200min
Physical	
Vibration Alert	Power on/off, Recording, Low battery
Dimension	141 × 77 × 15 (mm)
Weight	154 (g)

* Do not remove serial number stickers! Warranty is invalid if the sticker is tampered!

5

PV-PB30W

1080P Power Bank Wi-Fi DVR

Quick Guide

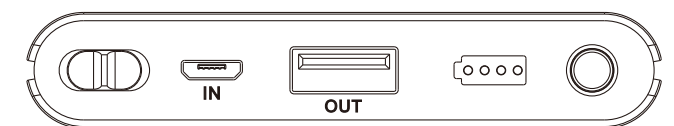

LawMate, innovation never stops

LawMate®