

80x120mm

1. Name and Parts

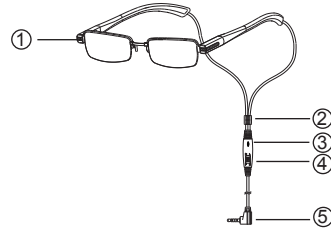

1. CMOS Lens
2. Wire Cord Organizer
3. Microphone
4. Video System and Audio Quality Dip Switch
5. AV Jack

2. Package Content

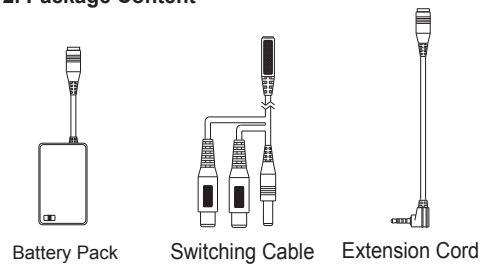

Battery Pack Switching Cable Extension Cord

(1)

3. Camera Setup Illustration

Connection with a portable DVR:

Analogue camera mainly uses to capture images.

1. Install the device as illustration shown below.
2. Insert the camera jack into A/V IN socket.
3. Press POWER-ON button on portable DVR about 3 seconds and release the button. Note that HOLD button should not be activated when press POWER-ON button.
4. A green light will turn on to show that DVR device is turn-on properly. Press REC button to start recording.
5. Captured images are automatically shown on LCD display.
6. Audio and video signals are automatically collected and saved into record folder in DVR.

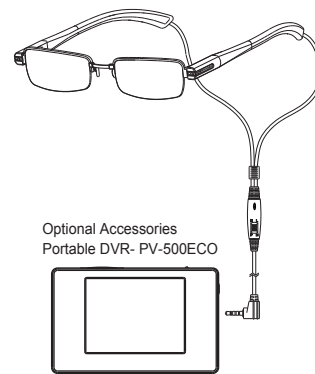

Optional Accessories
Portable DVR- PV-500ECO

(2)

Connection of AV Output:

Analogue camera mainly uses to capture images and output captured audio and video signals to an external display through AV switching cable.

1. Install the device as illustration shown below.
2. Slide the back cover of battery holder to open the battery tray. Insert a PP3 (9V) battery into battery tray. Switch to ON position.
3. The yellow and white color cable of switching cable are to connect with the external television/LCD.
4. Captured images are automatically shown on the connected LCD/Television.
5. Audio and video signals are transmitted to LCD/Television. Noted that external LCD/Television is required to connect with an audio and video recording device.

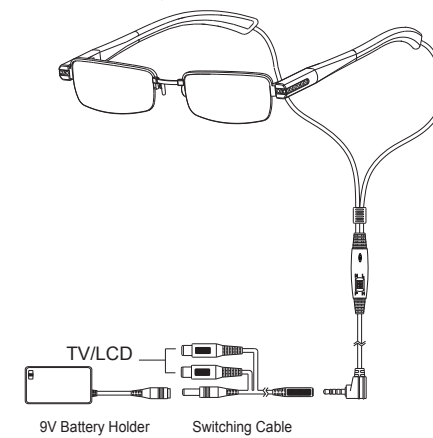

TV/LCD 9V Battery Holder Switching Cable

(3)

80x120mm

4. Setting Video Signal System and Audio Quality

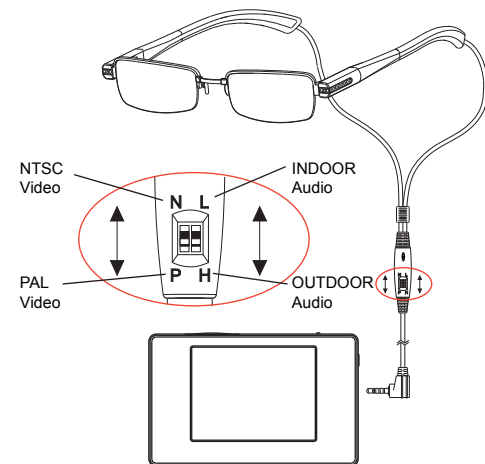

1. Make sure video system and audio quality is selected before turn on the DVR.
2. On the controller panel, there are two bar switch:
 - a. Switch to N to change video system to NTSC.
 - b. Switch to P to change video system to PAL.
 - c. Switch to L to record in indoor environment.
 - d. Switch to H to record in outdoor environment.

(4)

5. Connection with Wireless Equipment

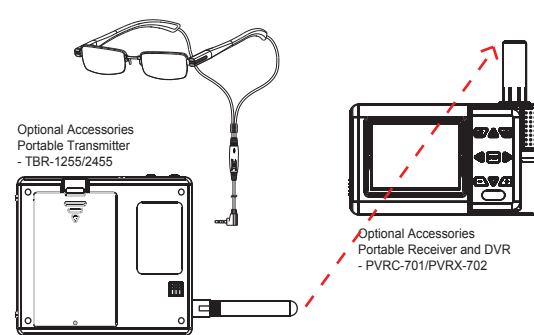

Optional Accessories
Portable Transmitter
- TBR-1255/2455

Optional Accessories
Portable Receiver and DVR
- PVRX-701/PVRX-702

1. Camera can also connect with RF wireless equipment.
2. Connect AV jack to portable transmitter.
3. Connect DVR or any recording device with portable receiver.
4. Set transmitter and receiver at the same frequency or channel.
5. Turn on receiver's power.
6. Captured images will be shown on receiver side.
7. Note that receiver should connect with external LCD / TV in order to display captured images.

(5)

CM-SG10 Spectacle Covert Camera Quick Guide

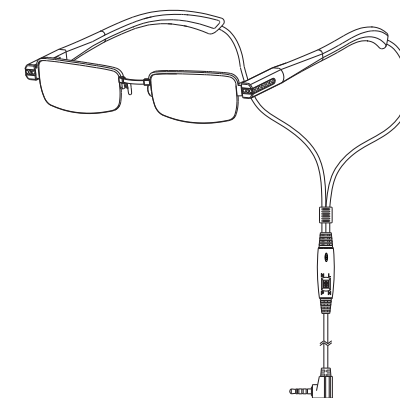

Law Enforcement Products Manufacturer

LawMate

V1.0