

1. Name and Parts

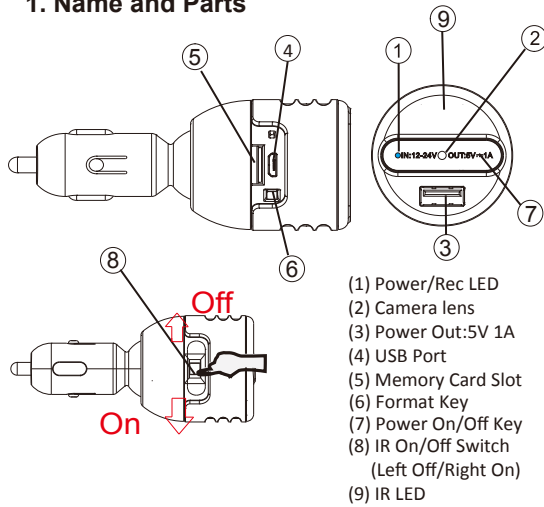

- (1) Power/Rec LED
- (2) Camera lens
- (3) Power Out:5V 1A
- (4) USB Port
- (5) Memory Card Slot
- (6) Format Key
- (7) Power On/Off Key
- (8) IR On/Off Switch
(Left Off/Right On)
- (9) IR LED

2. Package content

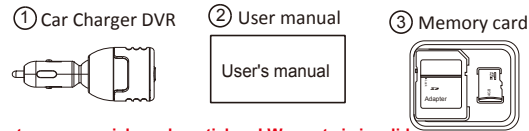

* Do not remove serial number stickers! Warranty is invalid if the sticker is tampered!

1

3. Date & Time setting (for Windows system)

- (1) From the desk top right-click to open Notepad, create a text (.txt) file named settime
- (2) On the first line of the file, enter date and time information as year.month.day hours.minutes.seconds. For example, suppose the time is October 16th, 2018 15:00. Then, please enter 2018.10.16 15:00:00
Note: There should be a space left between date and hour; time format should be the 24-hour format.
- (3) Save the file to the root directory of the memory card.
Note: If the setting is completed, the settime.txt file will not be visible when you connect the device to the computer again.

4. Operation

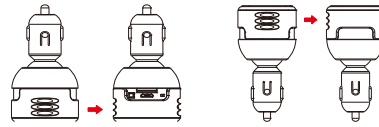

- (1) The power keys/USB port and memory card slot are designed on the side of the DVR that can be covered up by a hard shell.
- (2) You can decide whether to show or to hide the (4) (5) (6) and (8) by rotating the hard shell(as above picture shows).
- (3) You can adjust the camera lens direction by panning, tilting and rotating the base of the DVR.

2

* Power On the DVR Via Car Cigarette Lighter Socket

- (1) Recording: Switch (8) to the left to start the Rec. When you see the yellow/red LED is on, you know the Rec is on. To turn off the Rec, switch (8) to the right and the device will enter the standby mode. After 3 minutes of inactivity in standby mode, the device will be turned off automatically.
- (2) Plug the DVR directly to your car cigarette lighter socket and start the car.
- (3) Power off:
* There are three ways to turn the power off:
(The video clip will also be saved simultaneously when the power is turned off)
 - 3.1 If you turn off the engine, the DVR will also be turned off automatically
 - 3.2 Unplug the DVR from the car cigarette lighter socket, the DVR will also be turned off automatically
 - 3.3 Long Press (7) and the device will be turned off when the yellow LED is off.
- (4) IR LED:When you switch (8) to on, the recording video color will turn black and white. To turn off the IR LED, just slid the LED switch to off.
- (5) Charging the battery: When you plug the DVR to the car cigarette lighter socket and start the car, the internal battery will be charged automatically (internal battery is only used for saving the video clips when the engine is off).

3

* Battery-Powered,Car Engine is Off (Last Around 20 Minutes)

- (1) Short Press (7) and the device will be turned on when the yellow LED is on.
- (2) Recording: Switch (8) to the left to start the Rec. When you see the yellow/red LED is on, you know the Rec is on.
- (3) To turn off the Rec, switch (8) to the right and the device will enter the standby mode. After 3 minutes of inactivity in standby mode, the device will be turned off automatically. Long Press (7) and the device will be turned off when the yellow LED is off.

5. Format memory card

- (1) Press (6) and power on the DVR, the yellow LED will blink and shut itself off .
- (2) When the LED turns off, the format is completed.

6. Download the video to PC

* There are two ways to read the retrieve video files.

- (1) Use memory card reader to retrieve video files.
- (2) With the device powered on and memory card inserted, plug the USB cable into (4), and plug the other end into the PC.The device will be recognized by PC as an external drive for user to retrieve the files.

4

7. Specification

Built-in image sensor	Progressive 1/2.9 inch SONY CMOS
Sensor resolution	2000 x 1121
Sensor sensitivity	0.1 Lux @ F2.0 50IRE
Lens F/No.	F2.0
Focal Length	4.6mm
Angle of View	78.2°
Video Spec.	
Algorithm	H.264, JPEG
File Format	MOV
Video recording mode	Manual
Recording Capability	1920x1080
Frame rate	Up to 30 fps
Storage & I/O	
Memory type	Micro SD Card (Support SDHC max=32GB)
Data interface	Mini USB 2.0
Misc.	
Date/Time Table	YYYY/MM/DD, HH:MM:SS
Power	
Power Input	DC 12-24V
Power Consumption	260-300mA (IR OFF)(IR ON+330mA)
Battery Input	DC 3.7V / 130 mA polymers battery(XK032030)
Power Output	1.1A
Physical	
Dimension	9.5x4x4 (cm)
Weight	57G

5

PV-CG20 1080p Car Charger DVR (With Night Vision)

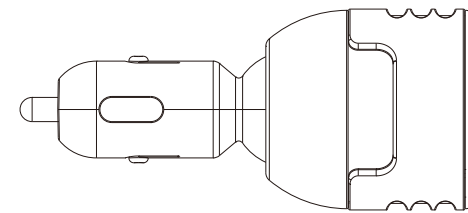
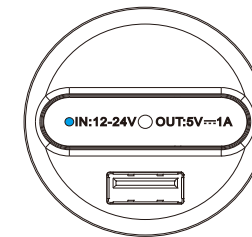

LawMate, innovation never stops

LawMate®