

### 1. Names and Parts

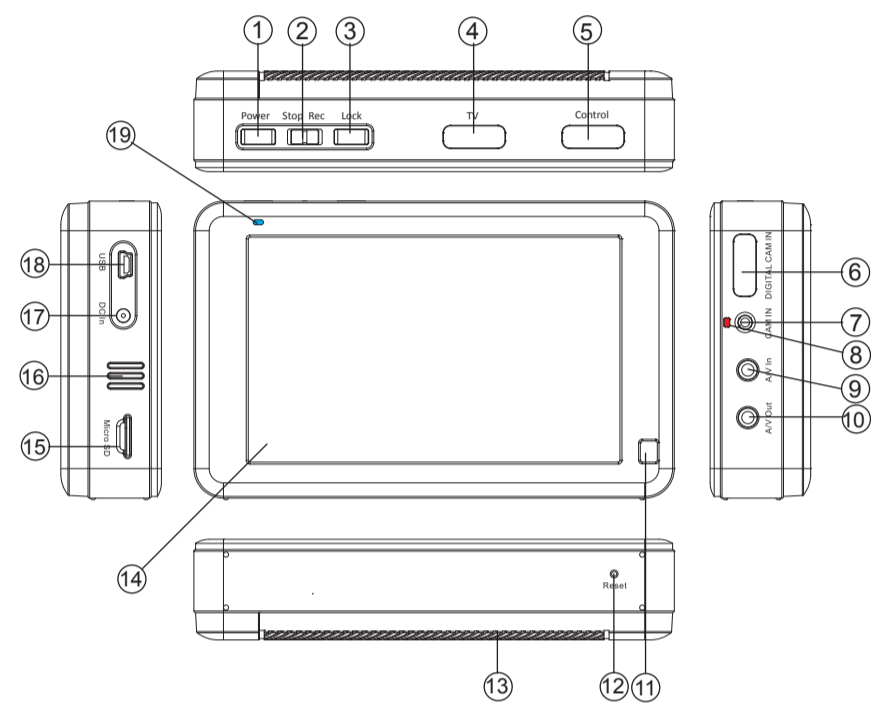

- |                    |                     |                         |
|--------------------|---------------------|-------------------------|
| 1. Power Button    | 7. Analog Cam In    | 13. Battery Compartment |
| 2. Stop/Rec Button | 8. Camera LED       | 14. 5" Touch Screen     |
| 3. Screen Lock     | 9. A/V In           | 15. Memory Card Slot    |
| 4. Digital AV Out  | 10. A/V Out         | 16. Speaker             |
| 5. Control Port    | 11. Infrared Sensor | 17. DC In               |
| 6. Digital Cam In  | 12. Reset Button    | 18. USB Port            |
|                    |                     | 19. LED Status Bar      |

1

### 2. Package Content

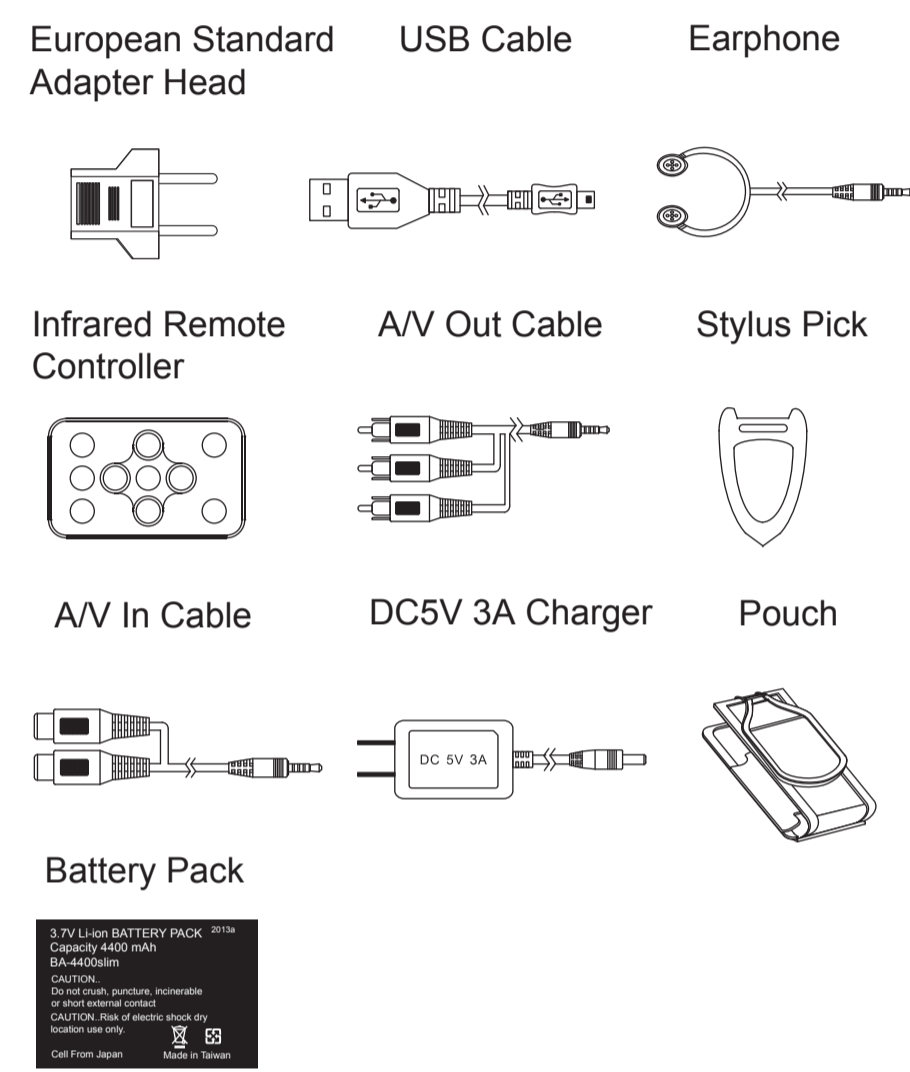

**Note: Do not use DC5V 2A charger to charge PV-1000TOUCH5. It may cause damage to the device.**

2

### 3. Install and Charge the Battery

- 3.1. Remove the battery cover  
Press ① and slide the rear cover at the red arrow pointed direction.

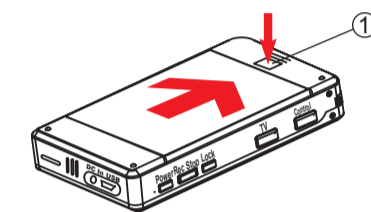

- 3.2. Insert the battery  
Align the golden contacts of the supplied battery with corresponding connectors on the PV-1000TOUCH5, then slide in the battery until it fits into place.

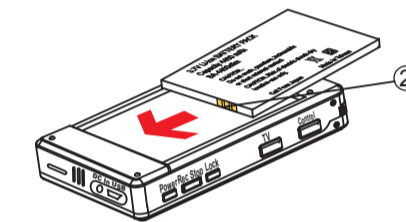

- 3.3. Charging the battery  
Plug the supplied DC 5V power adapter to an AC wall outlet then connect the other end of the power cord to the DC IN socket ③ on the side of PV-1000TOUCH5. The red LED indicator will illuminate on when the battery is charging. The red LED will turn off when battery is fully charged.

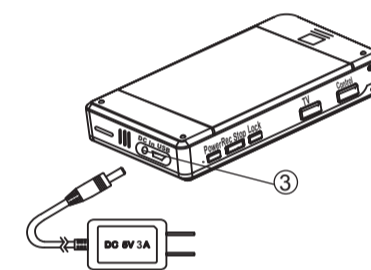

3

### 4. PV-1000TOUCH5 Connection Illustration

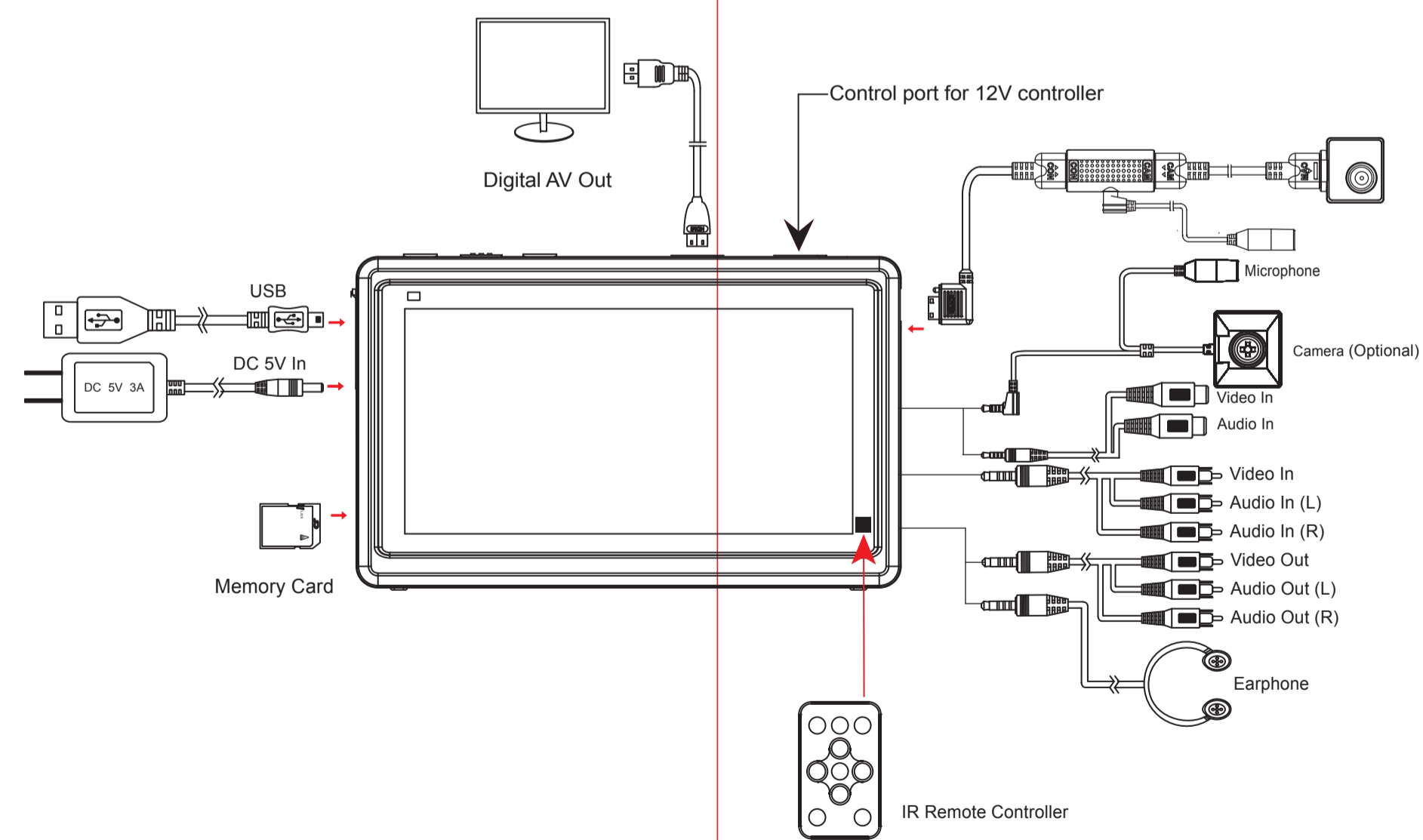

4

5

## PV-1000TOUCH5 5" Touch Screen Full HD Recorder Operation Manual

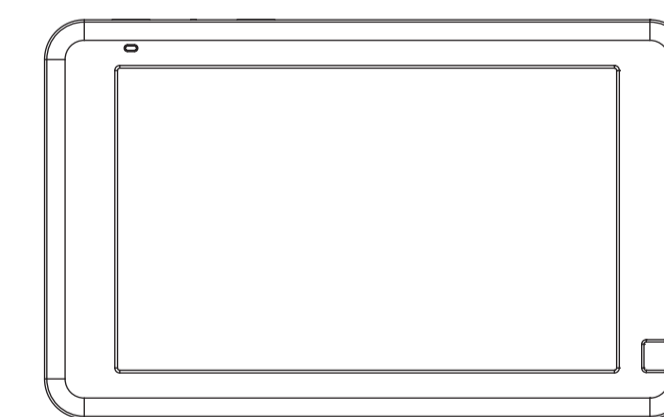

LawMate, innovation never stops

**LawMate**<sup>®</sup>

V1.1